

# Arizona Aikido Fall Mountain Camp September 4 – 7, 2014

## Thirty-Year Celebration!

This is the thirtieth year we have held a “Fall Mountain Camp” in Prescott, Arizona! We began the year the Jon Mamoru Takagi Sensei died, when we needed a time away together to grieve the loss of our Sensei and to celebrate a new beginning with our new Chief Instructor, Tsuneji Sakakibara Sensei. We continued the camp tradition through the years with many well-known featured instructors. The years have seen us train with Fumio Toyoda Sensei, Frank Doran Sensei, Frank McGouirk Sensei, Bruce Bookman Sensei, TK Chiba Sensei, George Ledyard Sensei, Mary Heiny Sensei, Lia Suzuki Sensei. Hiroshi Ikeda Sensei has been most supportive of this camp, serving as the primary featured instructor for at least 24 years! Come celebrate with us this year in Prescott!

## Featured Instructor



Hiroshi Ikeda Shihan is the founder and chief instructor of Boulder Aikikai in Boulder, Colorado. He currently holds the rank of 7th dan through Mitsugi Saotome Shihan and the Aikido World Federation.

Ikeda Sensei began his study of aikido in 1968, as a college student at Kokugakuin University in Tokyo. In 1978, he followed Saotome Sensei to Sarasota, Florida. In 1980, he moved to Boulder to establish Boulder Aikikai, an associate of Aikido Schools of Ueshiba. Ikeda Sensei developed the Bridge Seminars to bring together instructors and students from different organizations to further the growth of Aikido.

## Housing

While we encourage you to stay at the camp with us, lodging and food provided, we realize that staying at a hotel in town may suit some people better. This year we have reserved a few rooms at the Hotel Saint Michael in downtown Prescott. Contact the Hotel Saint Michael BEFORE August 1, 2014, and reserve one of the rooms with your credit card. Just let them know you are there with Arizona Aikido. Hotel Saint Michael: <http://www.stmichaelhotel.com/> (928) 776-1999 or email [hsmfrontdesk@cableone.net](mailto:hsmfrontdesk@cableone.net).

# Arizona Aikido Fall Mountain Camp September 4 – 7, 2014

## Cost

Full Camp 4 days (Thur. night to Sunday noon)	\$315
Full Camp 3 days (Fri. night to Sunday noon)	\$290
(Housing and meals are included in full camp. Bring bedding and toiletries.)	
Independent housing (stay in town in a hotel or motel)	
4 days (Thur. night to Sunday noon)	\$275
3 days (Fri. night to Sunday noon)	\$240
1 day with lunch (morning and afternoon sessions)	\$135
1/2 day no lunch	\$75
Thursday night class	\$50
Sunday class with lunch	\$80
1 meal	\$10
1 night stay	\$30
Banquet (included in Full Camp/Independent housing)	\$50

Early registration is appreciated!

Register online at <http://www.azaikido.com>. See the News item for the seminar for the registration link. Payment is accepted via PayPal, though you do not need a PayPal account to use your credit or debit card. You may send a check payable to Arizona Aikido to:

Arizona Aikido  
c/o Don Crawford  
2416 S. Mulberry  
Mesa, AZ 85202-7532

If you have questions or need special housing or transportation arrangements, please email [AZAikido@cox.net](mailto:AZAikido@cox.net).

## Schedule

### **First keiko is Thursday evening at 7:30 p.m.**

Morning wakeup – Liangong health qigong with Sharon Seymour Sensei 7:00 a.m.  
Breakfast 8:20 a.m.  
Morning keiko 9:45 a.m. – There are 2 morning sessions.  
Lunch 12:20 p.m.  
Afternoon keiko 2:00 p.m. – There are 3 afternoon sessions.  
Dinner 5:50 p.m.  
Aiki Store will be available in the main hall throughout the camp.  
Saturday evening—Banquet—Hotel St. Michael 6:30 p.m.  
Sunday morning – Mat pick-up after morning keiko

## Camp Location

**Emmanuel Pines Camp  
3000 Spence Springs Road  
Prescott, AZ 86305**

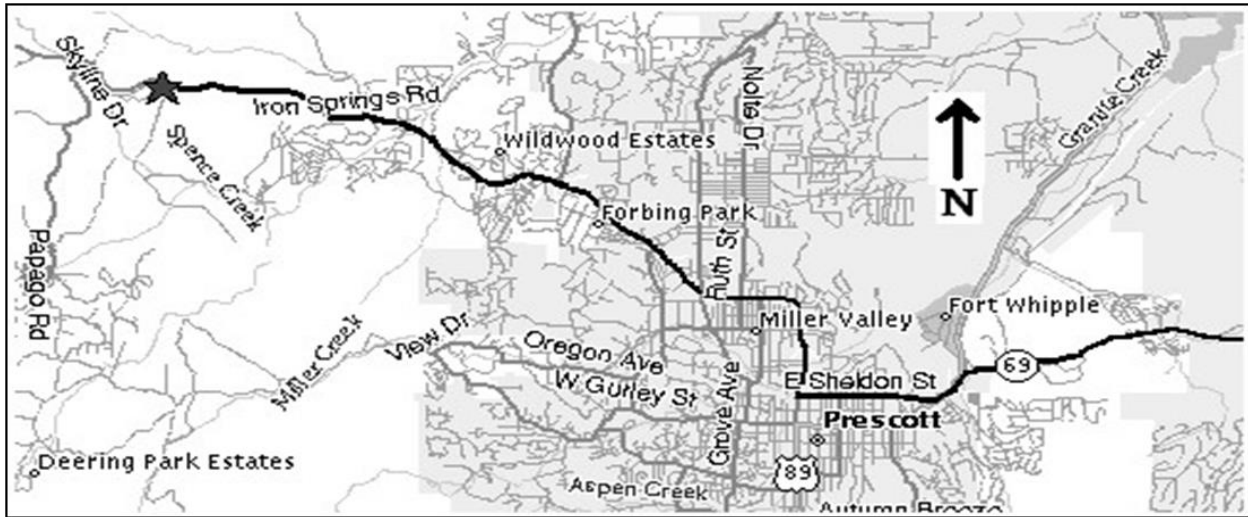

### DIRECTIONS TO CAMP:

**From Phoenix, take I-17 north 70 miles to Cordes Junction.**

**At Cordes Junction, take route 69 west 30 miles into Prescott.**

**In Prescott, just beyond Jct. 89, stay in the right lane to Sheldon.**

**Follow Sheldon to the bottom of the hill to the light at Montezuma.**

**Turn right (north) on Montezuma - it curves left (west) into Whipple. Continue on Whipple to the intersection of Miller Valley/Willow Creek. Go straight through at the light.**

**Whipple becomes Iron Springs Road after the intersection.**

**Continue on Iron Springs Road 3 miles to the Emmanuel Pines turnoff. The turnoff is on the left. Proceed 1 mile to camp.**

**Please drive slowly.**

**There are residences and speed bumps along the road into camp.**

**The pavement ends in about a half-mile.**

**Registration is in the dojo, the large building on the left as you enter Emmanuel Pines Camp.**